

# NFC LOCK

## ASSEMBLY AND OPERATING INSTRUCTIONS



CONTENTS

Introduction .....	3	Usermode / Operation (Smalox app) .....	13
Scope of delivery .....	4	Reset to factory settings (Smalox app) .....	14
Functional dimensions .....	5	Initial comm. Smalox Enterprise App (provisioning) .....	15
Components .....	6	Lock operating mode .....	16
Assembly and installation instructions .....	7	Safety and security instructions .....	17
Initial commissioning (provisioning) .....	10	Notes .....	18

## INTRODUCTION

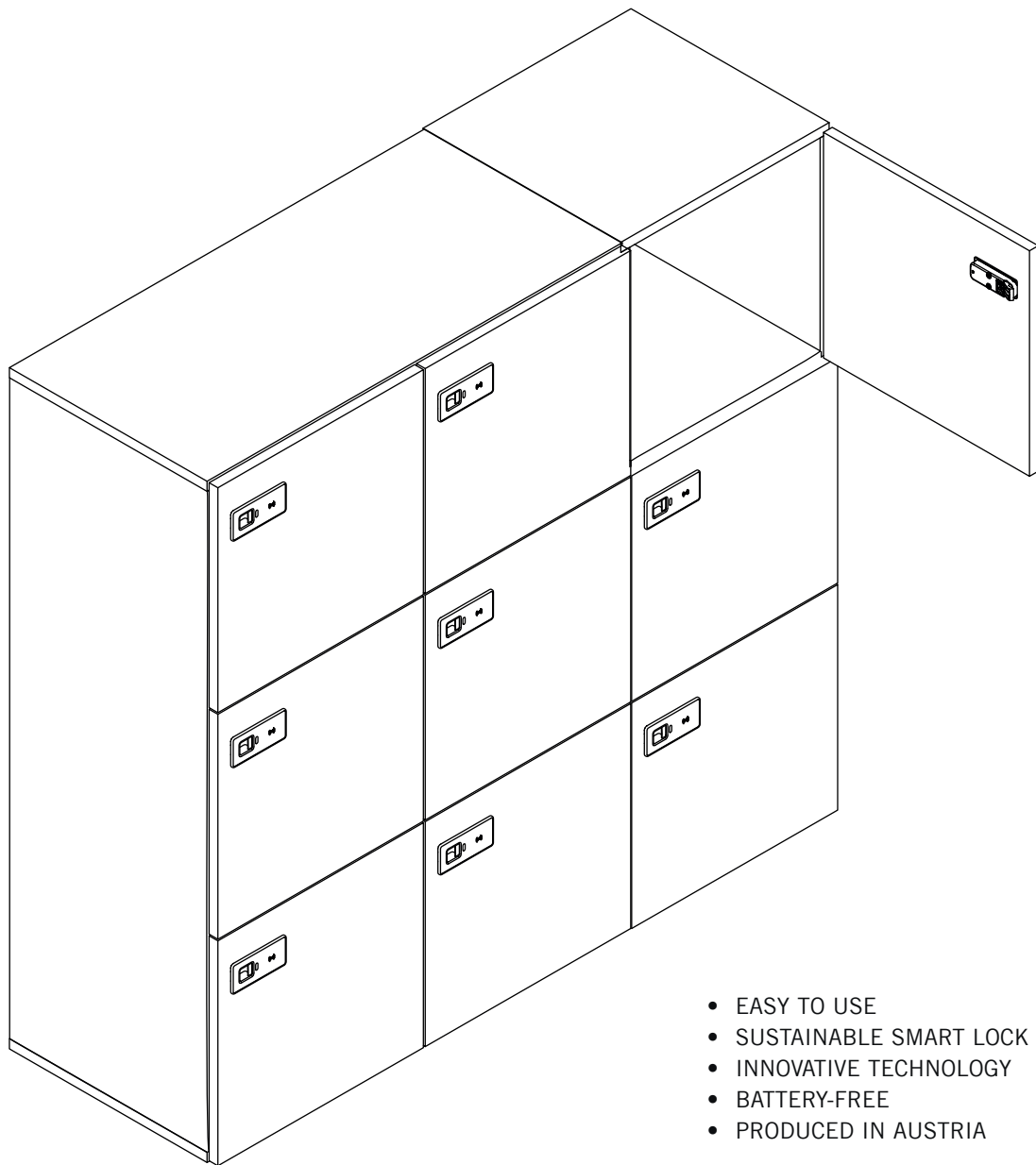

- EASY TO USE
- SUSTAINABLE SMART LOCK
- INNOVATIVE TECHNOLOGY
- BATTERY-FREE
- PRODUCED IN AUSTRIA

The NFC Lock in the Bene LOCKER\_S allows personal items to be stored simply and securely. No keys or batteries are required for operation – the NFC field of the smartphone is used to supply the power. Handling is straightforward since the lock is operated with an app. The elimination of cabling and batteries significantly reduces installation and maintenance workload. Optional management software is available for a large number of locks. This makes it easier for the facility manager to organise and assign authorisations.

## SCOPE OF DELIVERY

Scope of delivery: Factory-assembled set

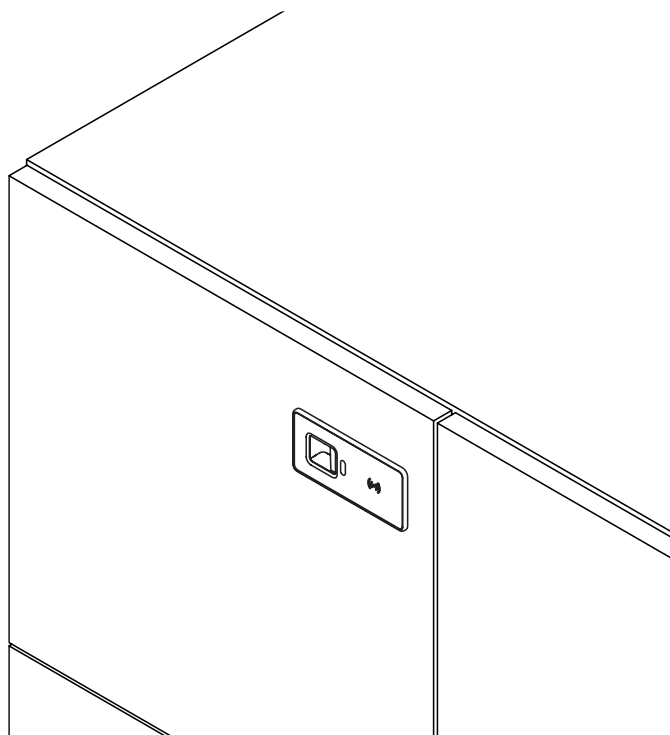

Scope of delivery: Supplemental set 1  
for mounting on outer side

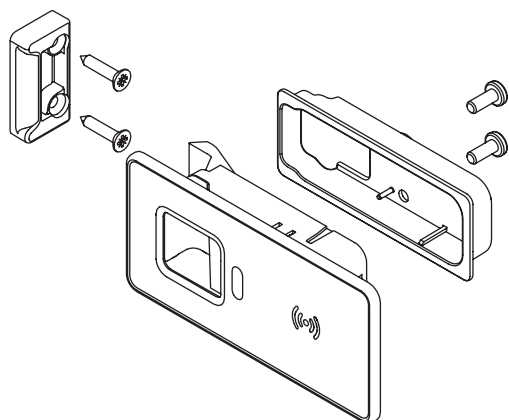

Scope of delivery: Supplemental set 2  
for mounting on centre side

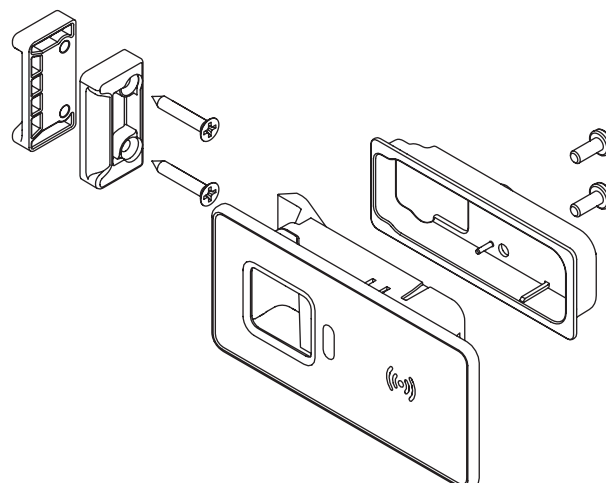

## FUNCTIONAL DIMENSIONS

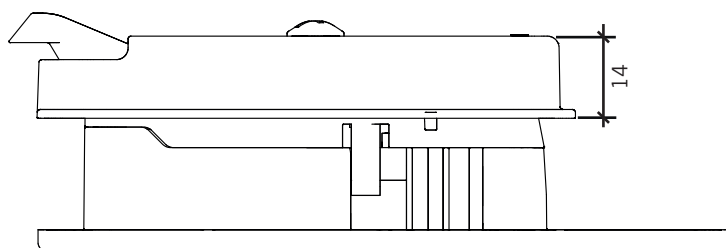
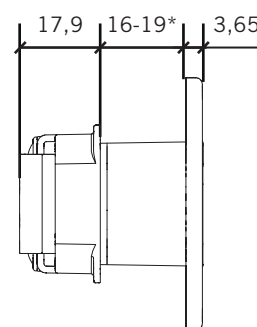
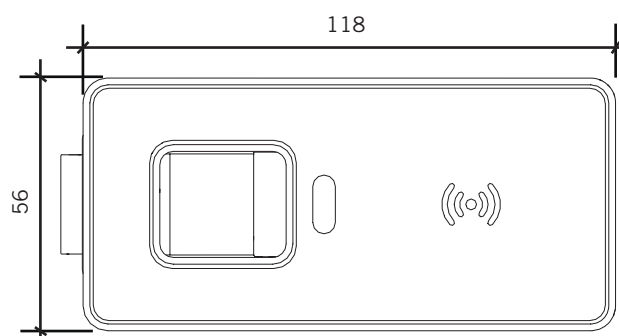

Dimensions in mm

**\* Requirements for the door**

Door material: Chipboard or MDF

Door thickness: 16 - 19 mm

## COMPONENTS

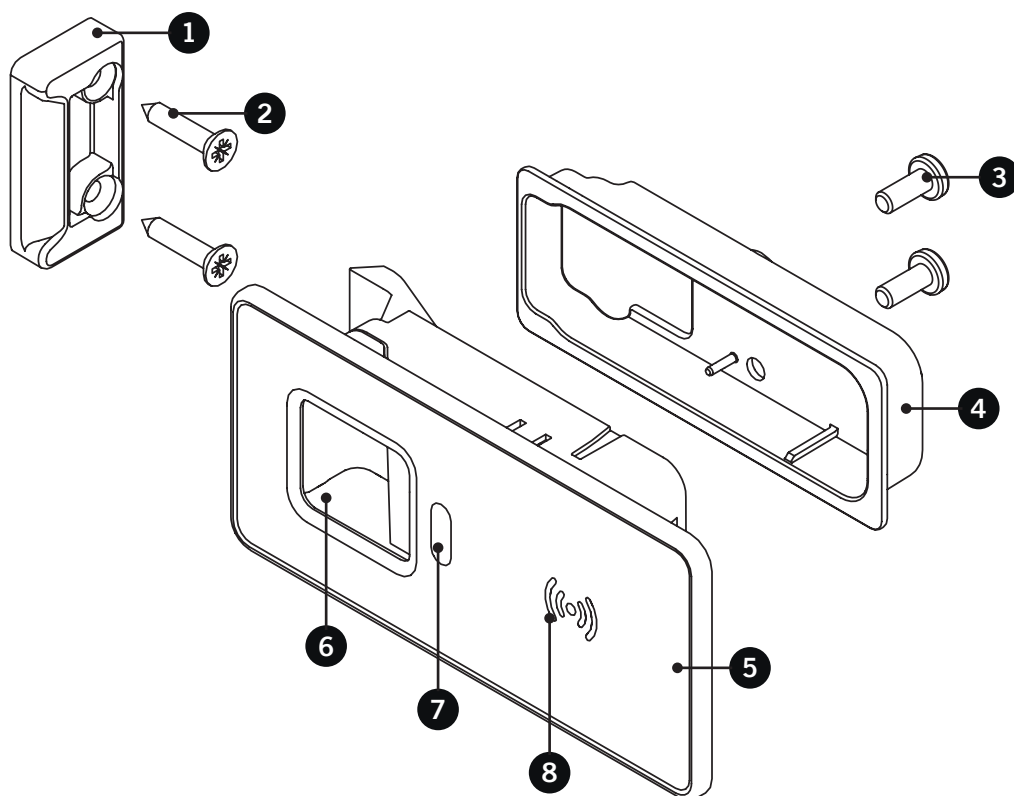

- |   |  |
|---|--|
| <b>1</b> Counterpart to locking mechanism       | <b>5</b> NFC Lock  |
| <b>2</b> Wood screws for mounting in the locker | <b>6</b> Release I handle                                |
| <b>3</b> Raised head screws                     | <b>7</b> Indicator: visual display of the opening status |
| <b>4</b> Mounting cover                         | <b>8</b> NFC antenna area                                |

## ASSEMBLY AND INSTALLATION INSTRUCTIONS

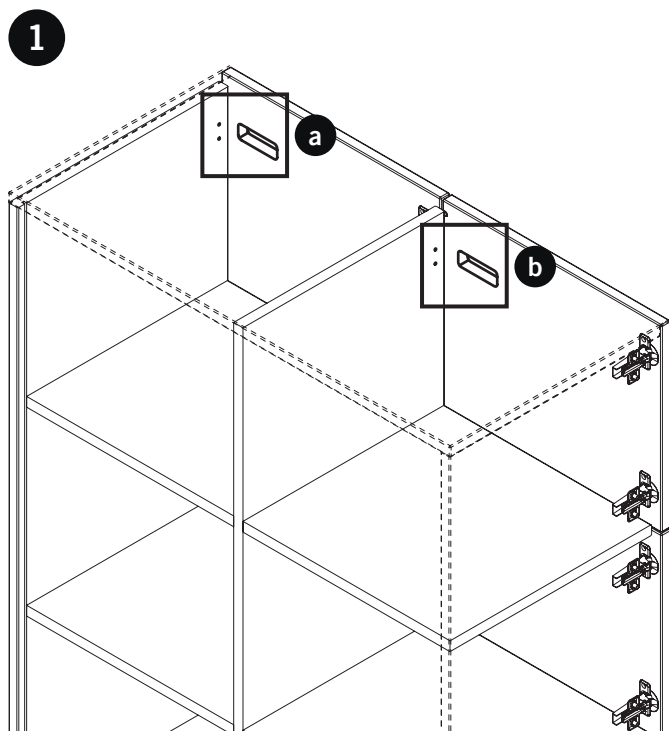
**Dimension and position of the cut-out**

The following cut-out is required in the locker door to install the NFC Lock.

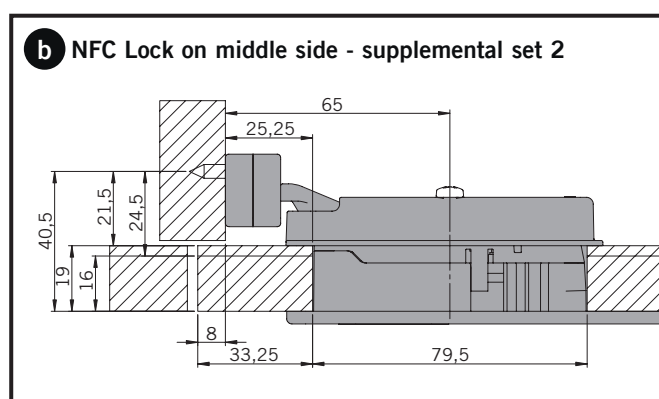
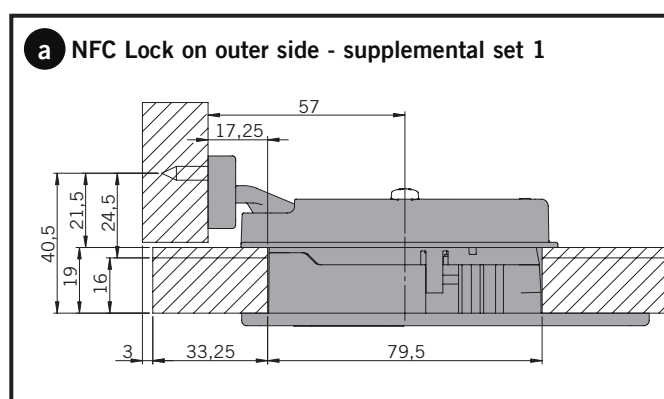
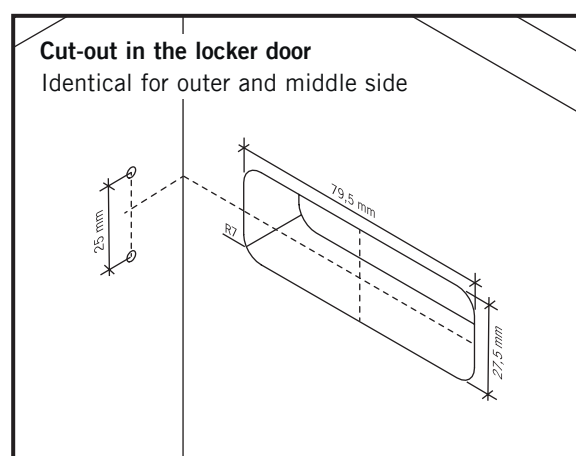

## ASSEMBLY AND INSTALLATION INSTRUCTIONS

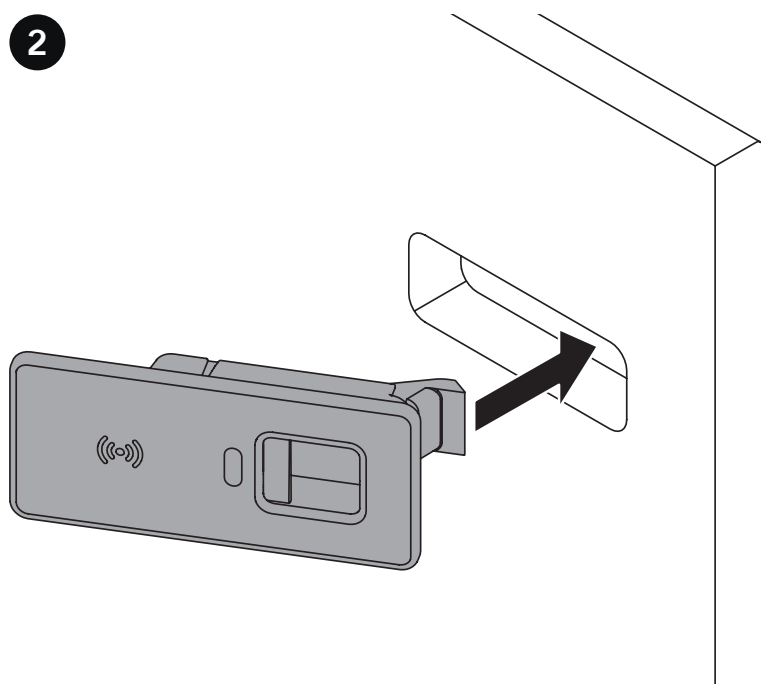

2

**Positioning the lock**

Insert the lock into the cut-out in the locker door from the front.

Note: Pay attention to the stop side!

3

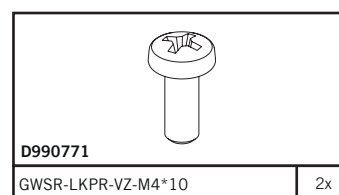
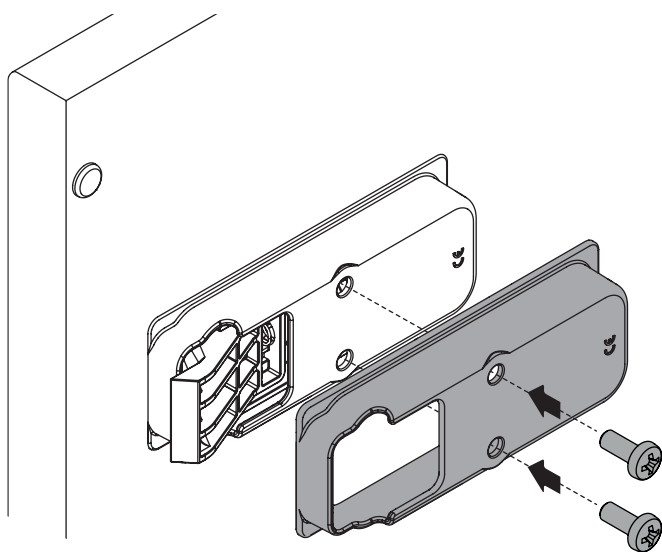
**Mounting the lock**

Place the mounting cover on the lock from the back side and screw it in place using the raised head screws supplied and the specified torque (1 Nm).

## ASSEMBLY AND INSTALLATION INSTRUCTIONS

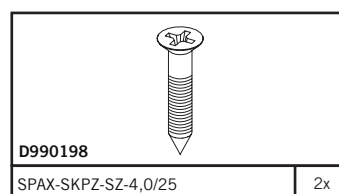
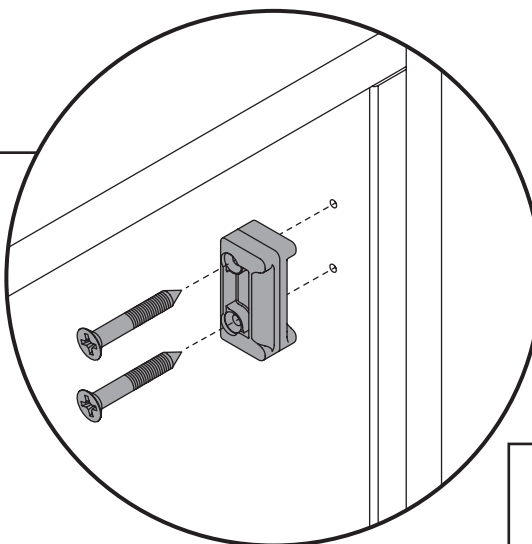
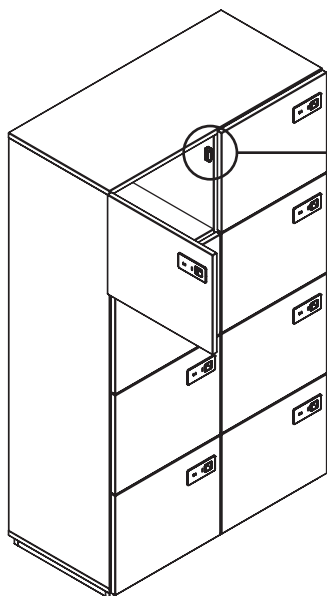

4

**Mounting the counterpart on middle side**

Screw the counterpart to the locking mechanism into the locker in the following position using the wood screws.

5

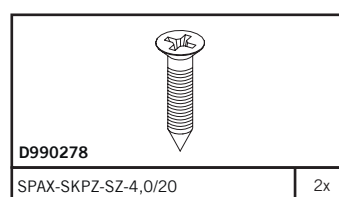
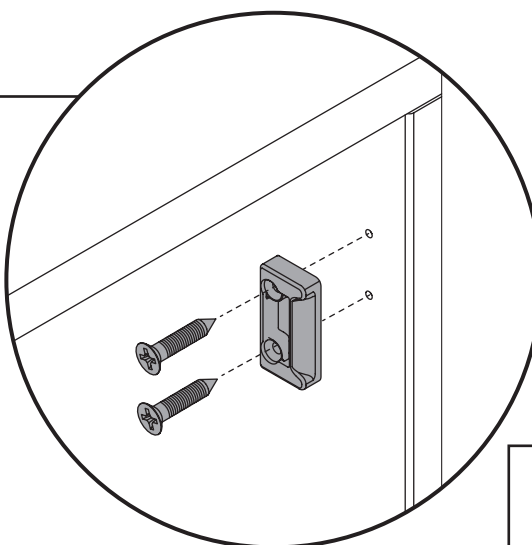
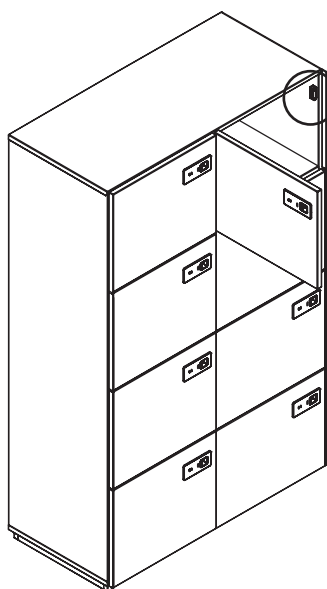
**Mounting the counterpart on outer side**

Screw the counterpart to the locking mechanism into the locker in the following position using the wood screws.

## INITIAL COMMISSIONING (PROVISIONING)



The NFC Lock always requires the corresponding app (either SMALOX App or SMALOX Enterprise App) on the mobile phone for operation.

Prerequisite for the functionality of the app:

- Android 8.0 or higher
- iOS 14.0 or higher

### Initial commissioning (provisioning) of the NFC Lock

An administrator must be assigned to each NFC Lock during initial commissioning (provisioning). Provisioning must be carried out once by the company's IT department or facility manager.

With this step, the NFC Lock switches from factory settings to operating mode. This applies to use with both the SMALOX app and the SMALOX ENTERPRISE app.

Without the initial commissioning (provisioning), the NFC Lock has no information about the environment (client) or the mode used (stand-alone or cloud service) and is therefore not functional.

Two operating modes are available for the NFC Lock:



with the SMALOX app or



with the SMALOX ENTERPRISE app

### Commissioning (provisioning) with the SMALOX app stand-alone variant, free operation without cloud service

1

Please download the SMALOX app from the iOS App Store or the Android Play Store. The app guides you through the steps of the initial commissioning of the NFC Lock. The person who commissions the lock for the first time (provisioning) automatically becomes the administrator. During the process, you will be prompted to enter and change the default administrator password set at the factory.



Smalox



iOS App Store



Android PlayStore

2

When opening the app for the first time, you can see an animation that shows you how to hold the mobile phone correctly against the lock in to achieve an optimal energy transmission (NFC).

The NFC unit is located in the upper left area of iOS devices (Apple), in the middle of the housing of Android devices and varies slightly from device to device.

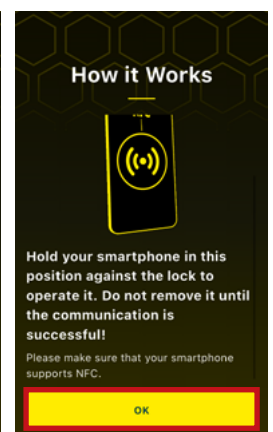
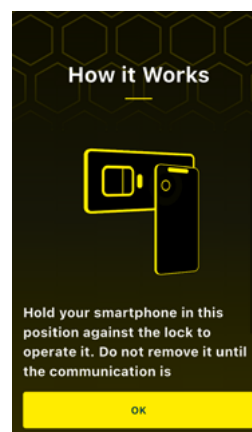

## INITIAL COMMISSIONING (PROVISIONING)

3

An NFC Lock shall be added.  
Press the + Icon.

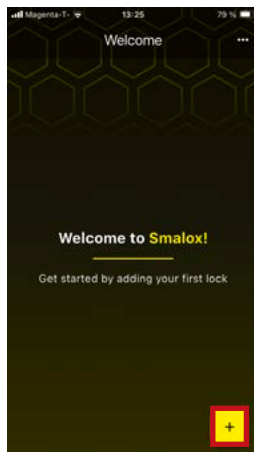

4

The operation mode and the current state of the NFC Lock is scanned and retrieved.

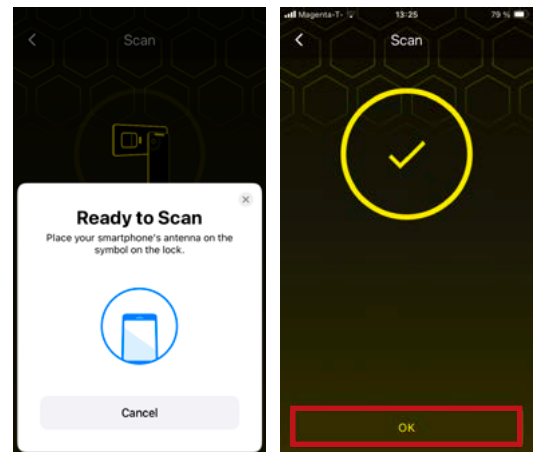

5

In the next step, the corresponding mode must be assigned to the NFC Lock during initial commissioning (provisioning).

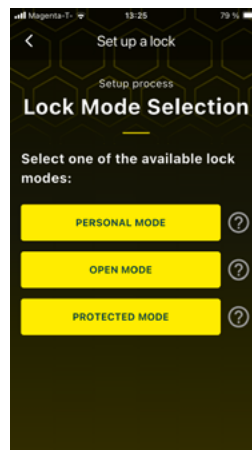

6

In the SMALOX App (Stand-alone version without Cloud Service), three different modes are available.

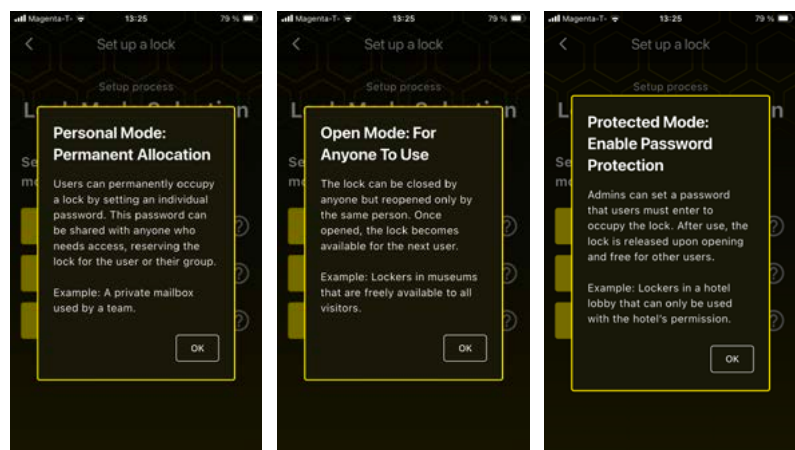

## INITIAL COMMISSIONING (PROVISIONING)

7

Select the chosen mode.

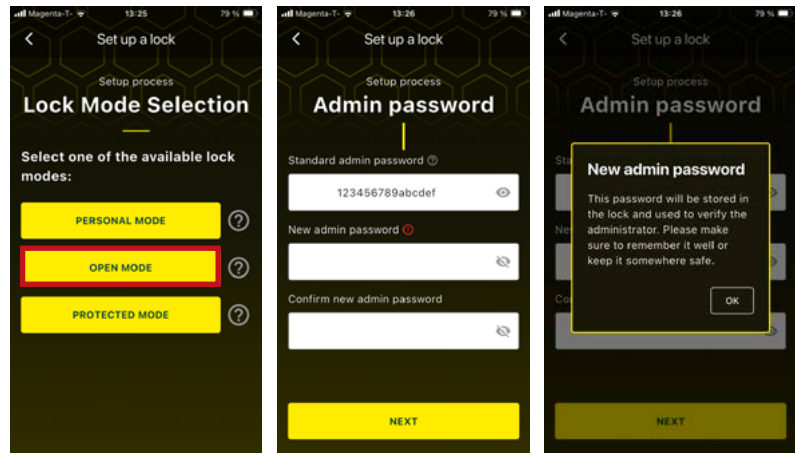

**ATTENTION:** The NFC Lock may **only be put into operation by an authorized person in the company** (e.g. facility management, IT representative, etc.). The person who puts the lock into operation for the first time (provisioning) is **automatically the ADMINISTRATOR** and the information is stored in the lock. The default administrator password is the same for all NFC Locks that are set to factory settings (factory delivery status) and is: **0123456789abcdef**

It is strongly recommended to set a new administrator password. This is required every time the administrator mode is called up and increases security and protects against unauthorized access. If the newly set administrator password is forgotten or lost, it can no longer be reset to the default administrator password (factory setting)! The compartment/NFC lock can then only be opened by force - the lock becomes unusable and must be replaced!

Without the administrator password:

- emergency opening is not possible
- the lock mode cannot be changed
- the NFC Lock cannot be reset to factory settings

It is therefore strongly recommended to make the newly set administrator password accessible to a second trusted person or to keep it in a safe place.

8

Initial commissioning (provisioning) of the NFC lock is now complete.

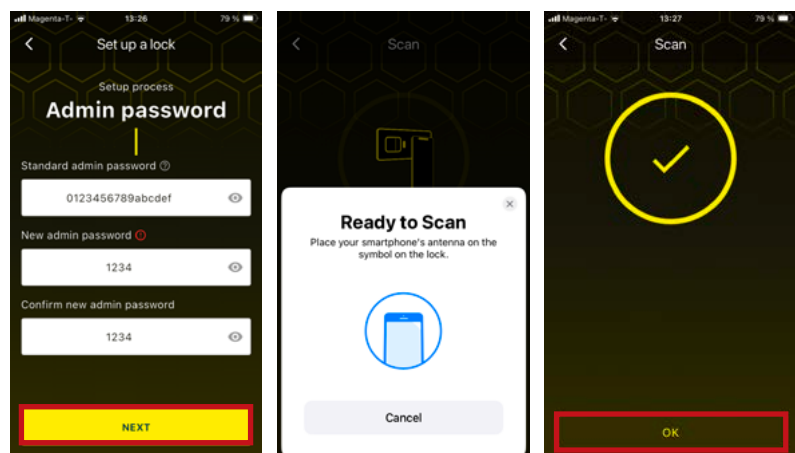

## USERMODE / OPERATION OF THE SMALOX APP

1

Open and close the lock with SMALOX Stand alone app in the mode “OPEN MODE”

Now the “normal” user mode begins and the lock can be used by anyone.

To do this, add an (already provisioned) NFC lock and scan...

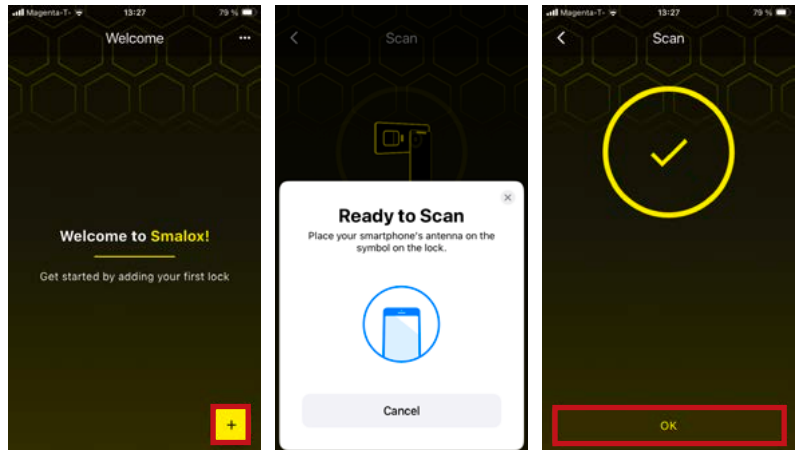

2

An individual name can be assigned to the NFC Lock for easier identification. This makes it easier to find the NFC Lock later in the app.

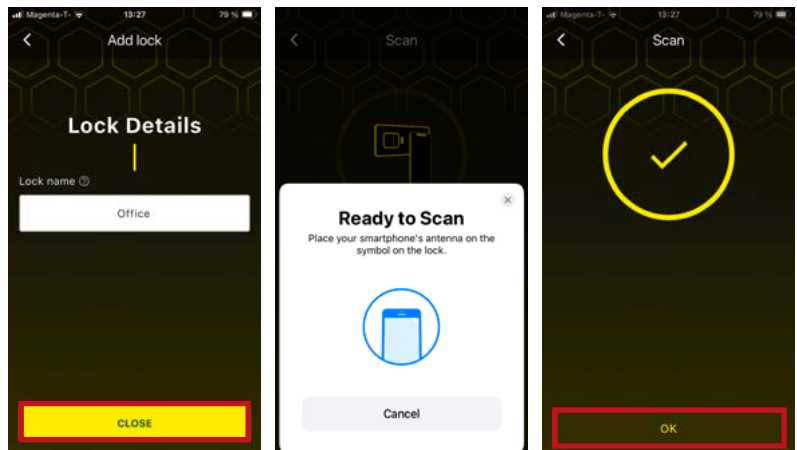

3

All booked NFC Locks can be found in this list.

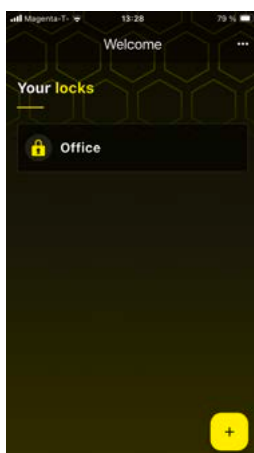

4

The lock can be opened or closed again as required, depending on the mode selected.

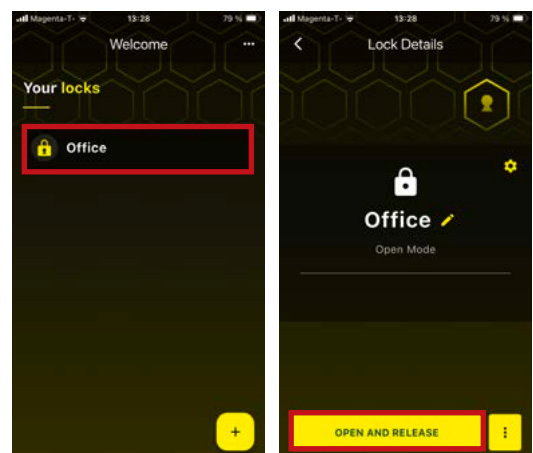

## RESET THE NFC LOCK TO FACTORY SETTINGS WITH THE SMALOX APP

**1**

**Administrator mode - Reset NFC Lock in the SMALOX app (stand-alone version) to factory settings**

The following steps are necessary to restore the factory settings:

First, the administrator mode must be activated. This is done via the menu (three dots top right). The smartphone must then be held against the NFC lock that you want to reset.

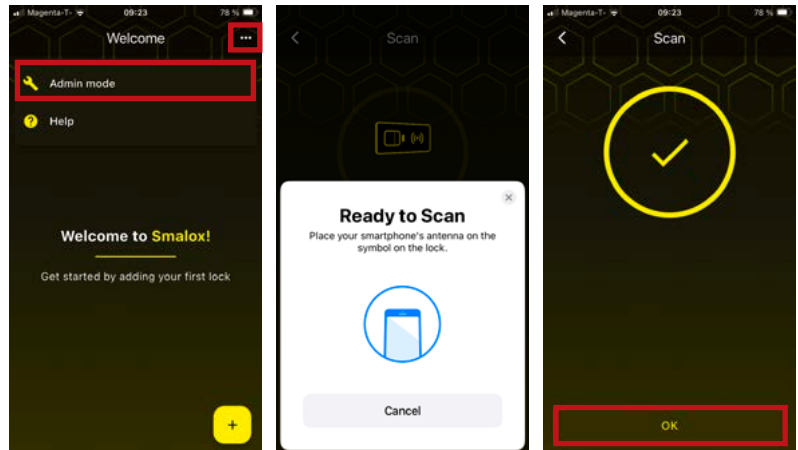
**2**

Enter the administrator password set during initial commissioning (provisioning).

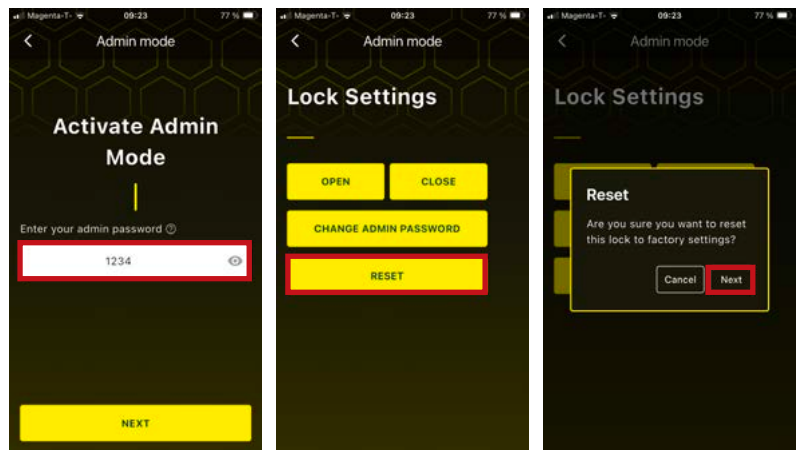

The NFC Lock can now be reset to the factory settings (status at factory delivery). After scanning the lock again, this process is complete.

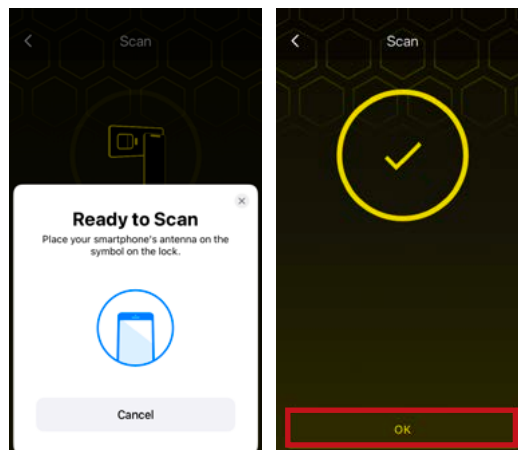

## INITIAL COMMISSIONING SMALOX ENTERPRISE APP (PROVISIONING)



Initial operation with the SMALOX ENTERPRISE app



SMALOX  
Enterprise



iOS App Store



Android PlayStore

Operation is carried out with the SMALOX ENTERPRISE or SMALOX ENTERPRISE PREMIUM management software, which is subject to a charge and includes a cloud service. The desktop-based management software offers convenient administration of access and usage authorisations. It is available in two expansion stages:

- SMALOX ENTERPRISE
- SMALOX ENTERPRISE PREMIUM

Both versions differ in their range of functions in terms of connection, administration, authorisation assignment and evaluation (see table for details).

### Functions of the management software:

- **Management of administrators and users:** Administrators and users can be defined and managed centrally (by IT or the facility manager). Authorisations can be easily assigned or withdrawn.
- **Extended functions in SMALOX ENTERPRISE PREMIUM:** Thanks to the cloud connection, the software can be seamlessly integrated into the company's IT environment via SSO (single sign-on). Employees use their company login data, allowing authorisations to be managed centrally by IT.

Detailed information on the range of functions and the provisioning process can be found at <https://www.smalox.com/office-furniture>

## LOCK OPERATING MODE

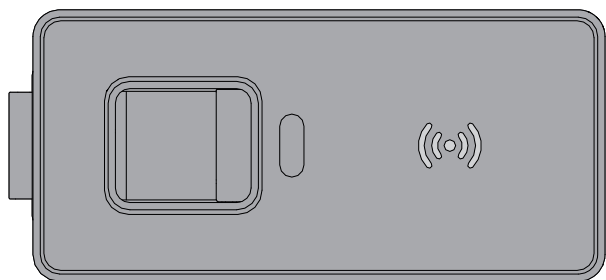

Lock open

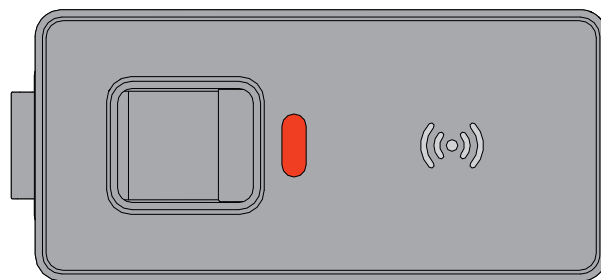

Lock locked

## SAFETY AND SECURITY INSTRUCTIONS



### Safety instructions for the storage space

- Always hold doors by the handles!
- Before moving the furniture, empty the storage space and close the doors. If required, use adhesive tape to keep them closed!
- The maximum load capacity of the shelf must be taken into account. The maximum load can be found in the corresponding product information.

### Security instructions for the NFC Lock

- Access control: Ensure that only authorised individuals have access to the installation location of lockers with the NFC Lock.
- Regular updates: Always keep the operating software and the software application (SMALOX/SMALOX Enterprise) on your mobile phone up to date in order to avoid any security vulnerabilities and to allow the use of new functions.
- Secure authentication: Use strong, unique passwords for the (initial) login to increase security.
- Regular check: Regularly check the functionality of the lock and the associated devices to ensure that everything is working properly.
- If you have not purchased management software, keep a list of users and their access rights so that you can track who has access to the NFC Locks at all times.
- Training: Inform all users about the correct handling and safety practices when using the electronic NFC Lock.
- Recommended installation torque: 1 Nm
- The NFC Lock is intended for indoor use: Temperature range +5°C to +40°C
- IP protection class: IP52
- Maximum static load: 350 N (force applied to the lever)
- RoHS & REACH compliance: Yes. CE conformity: Yes
- Operating system compatibility: Android, iOS
- Communication & energy transmission: NFC
- A compatible mobile phone  
(with NFC functionality) and the appropriate software are required to operate (lock and open) the NFC Lock.
- Requires Android 8.0 or higher, iOS 14.0 or higher

## NOTES



